

Swivel Plate

JTW Series Jacks

Model	Dimensions (mm)										
	A	B	C	E	F	H	K	M	N	Q	T
1T	122	159	25	85	104	9	37	95	179	20	25
2.5T	167	197	35	90	122	14	50	135	242	25	35
5T	210	253	45	114	158	17	58	168	305	35	45
10T/15T	240	317	55	155	202	21	63.5	190	355	45	55
20T	295	353	65	160	218	28	95	240	430	50	65

JT Series Jacks

Model	Dimensions (mm)										
	A	B	C	E	F	H	K	M	N	Q	T
0.5T	119	125	20	60	82	9	30	96	164	15	20
1T	119	140	25	66	85	9	35	100	174	20	25
2T	135	165	35	66	90	12	38	111	210	25	35
3T	156	185	35	80	110	12	42	125	231	25	35
5T	173	217	45	90	122	14	45	140	268	35	45
10T	233	257	55	100	142	18	70	190	348	45	55
15T	233	267	55	110	152	18	70	190	348	45	55
20T	255	318	65	140	183	18	75	210	390	50	65

Swivel Plate

JTC Series Jacks

Model	Dimensions (mm)										
	A	B	C	E	F	H	K	M	N	Q	T
2.5KN	60	74	10	38	50	M6	16	48	84	10	15
5KN	80	106	15	52	72	M8	21	60	114	15	20
10KN	100	130	20	63	85	M8	29	78	145	20	25
25KN	130	150	20	81	105	M10	42	106	175	25	30
50KN	180	210	30	115	145	M12	63	150	245	35	40
100KN 150KN	200	240	35	131	165	M20	66	166	275	45	50
200KN 250KN	240	305	40	170	220	M30	75	190	325	50	60

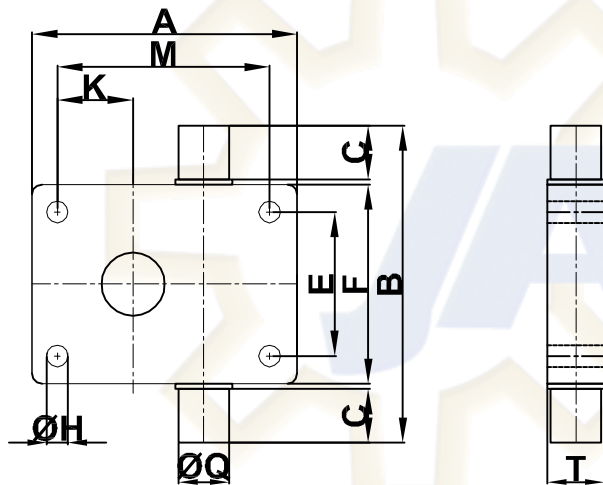

Transverse

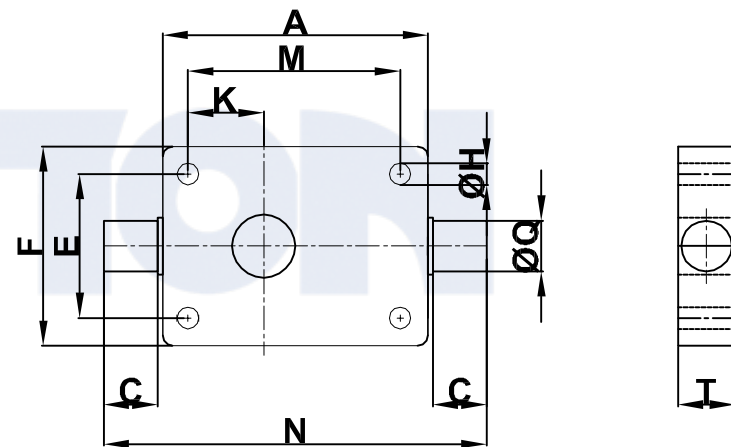

Standard